Low-Q S-Band BPM Status

21th Dec. 2007

KNU

Eun-San Kim

Design of S-band BPM

1. Initial design parameters

TABLE Design value.

Mode	f (GHz)	Q_0	β	Q_{ext}
Dipole	2.878	5075	6.8	750

2. Electrical dimension of low-Q S-band BPM

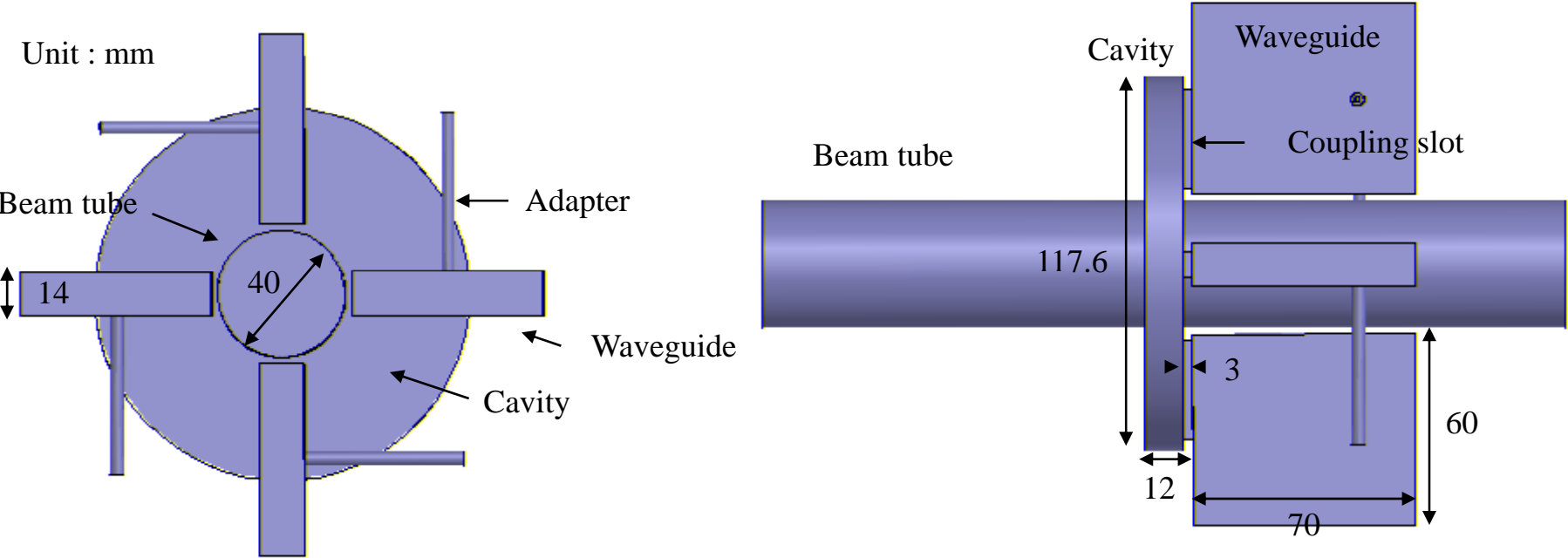

Fabrication of S-band BPM

1. Mechanical drawing

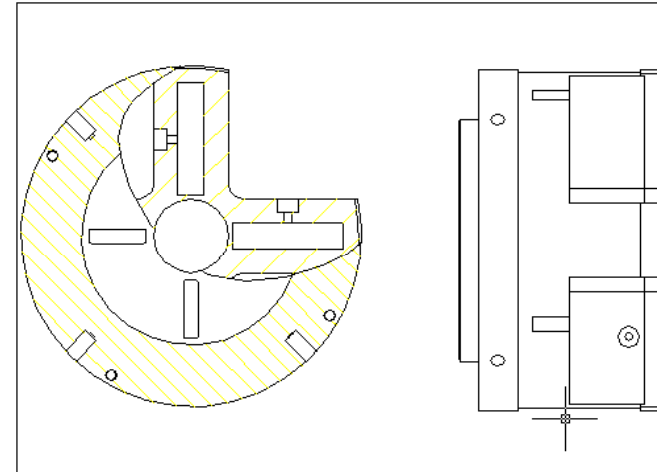
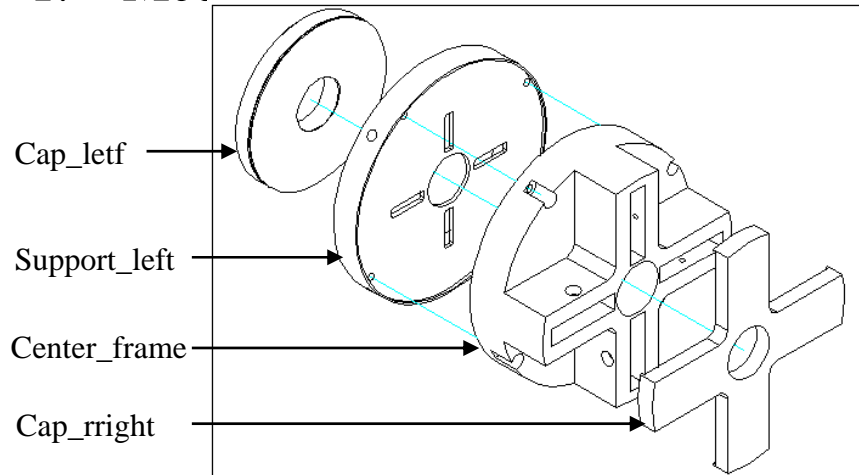

2. Machine Shop in KNU



Fabrication of S-band BPM

BPM parts

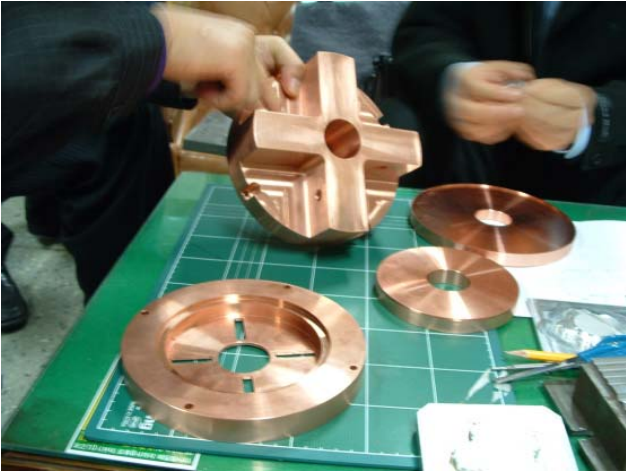

Center_Frame

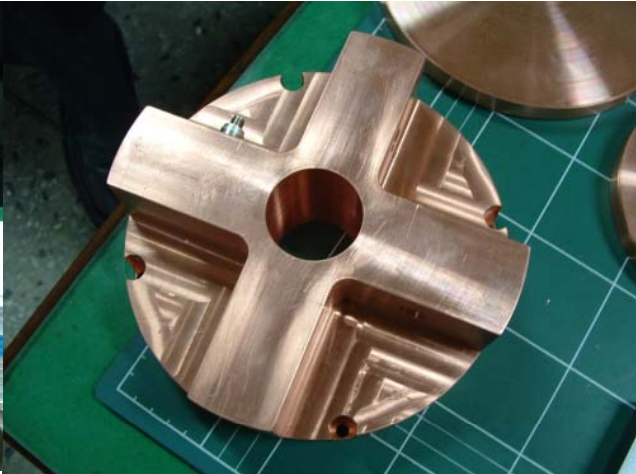

Milling & Lathe machines

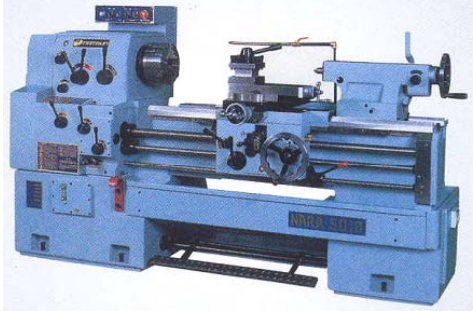

Support_Left



Cap_Left



Machining Jig



Fabrication of S-band BPM

Wire-cutting for cavity of the BPM



[Center_Frame]

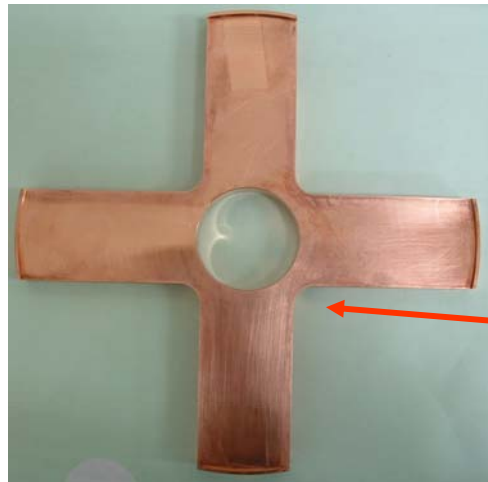

[Cap_Right]



Summary

1. RF tests of a proto-type will be started in next week.
2. Two low-Q S-band main BPMs will be fabricated until March 2008.