

ATF and ATF2 floor

Junji Urakawa

Nobuhiro Terunuma

KEK

ATF2 Construction Schedule

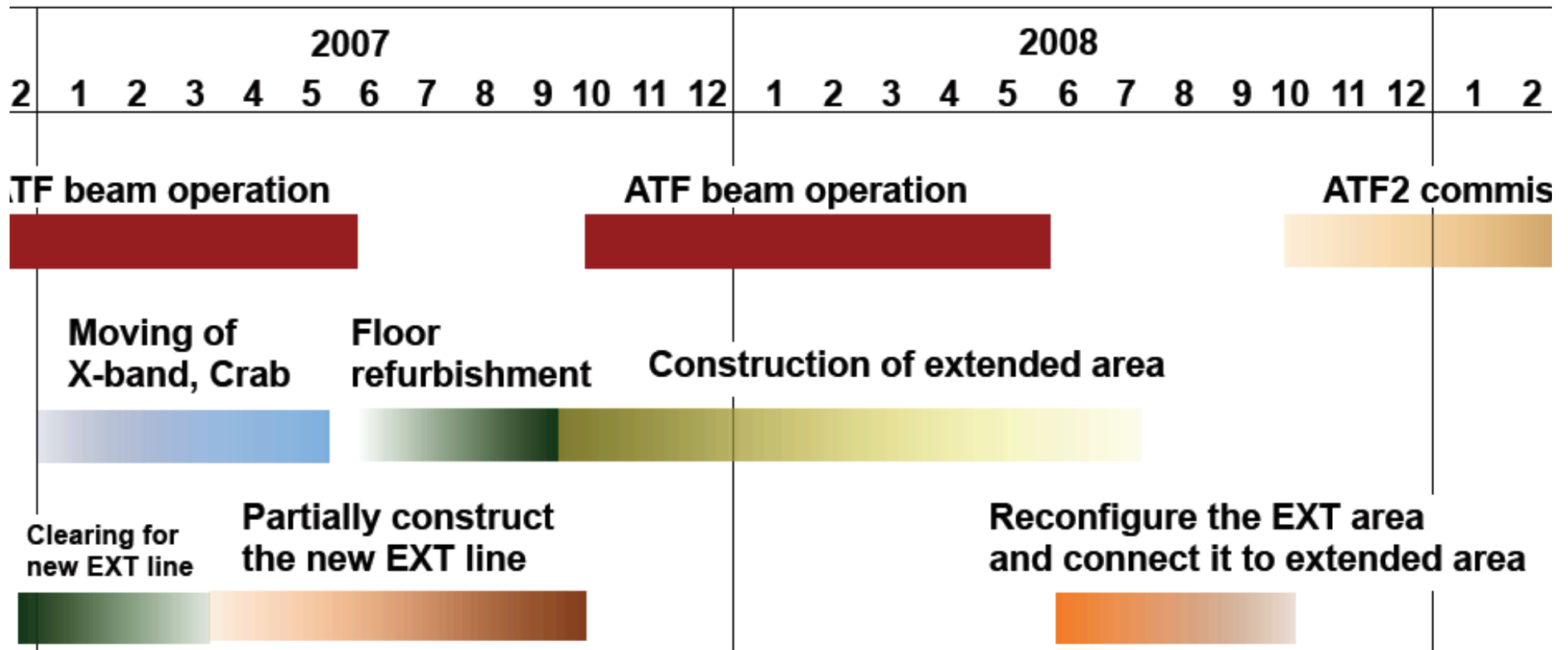

Prepare for partial construction of ATF2 beam line

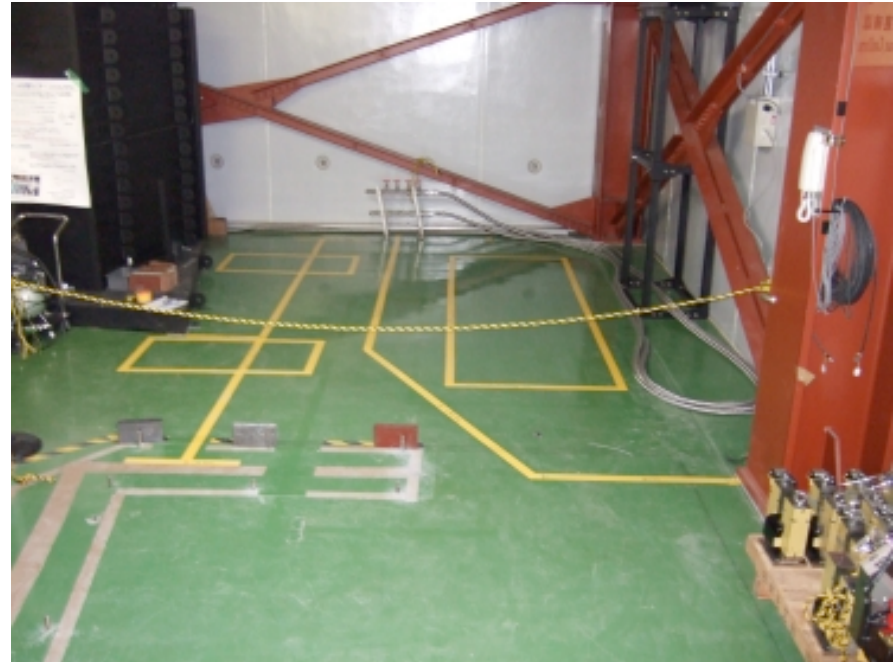

Shield walls for pol. e^+ detector has been removed. We will start the partial construction of ATF2 beam line in this summer.

Installation of ATF2 Quad into EXT





Crab Cavity, Dec 2006



X-band, Dec 2006



March 2007

Area for ATF2 beam line

X-band Test Station has been cleared. Movement of Crab Cavity group are in progress.
Floor refurbishment will start after June 18, 2007.

Floor structure for DR and EXT

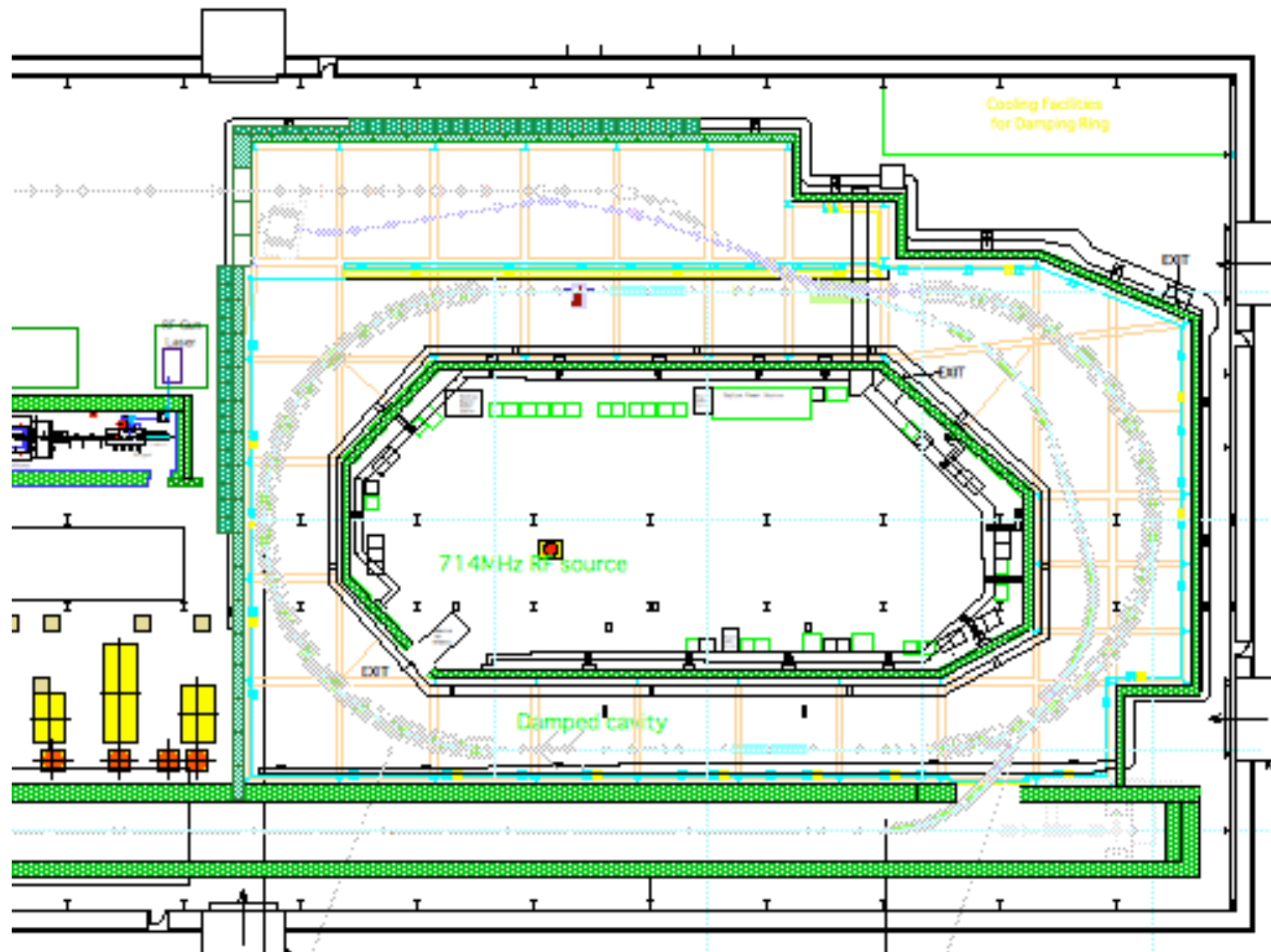

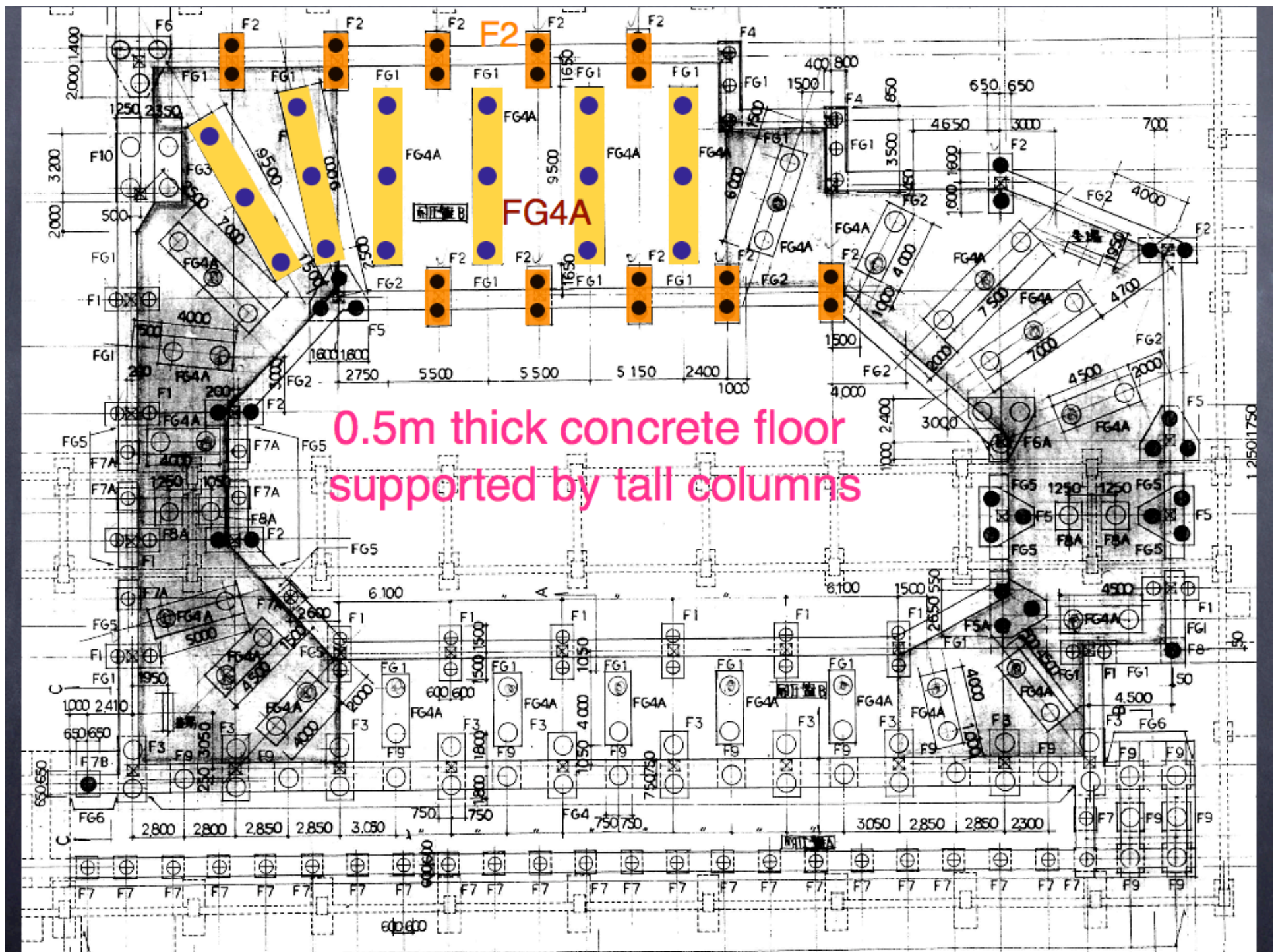

FG4 .(FG4A)

全断面

Cross section

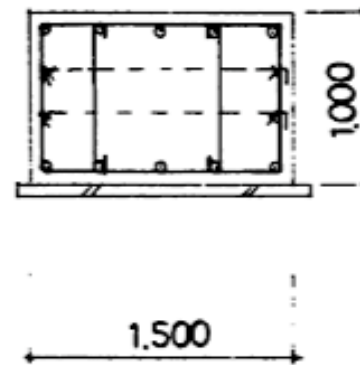

unit=m	F2	FG4A
Concrete Block		
height	1.2	1.0
width	1.5	1.5
length	3.2	9.6
Supporting Column		
number	2	3
diameter	0.8	1.0
tallness	12.4	12.8

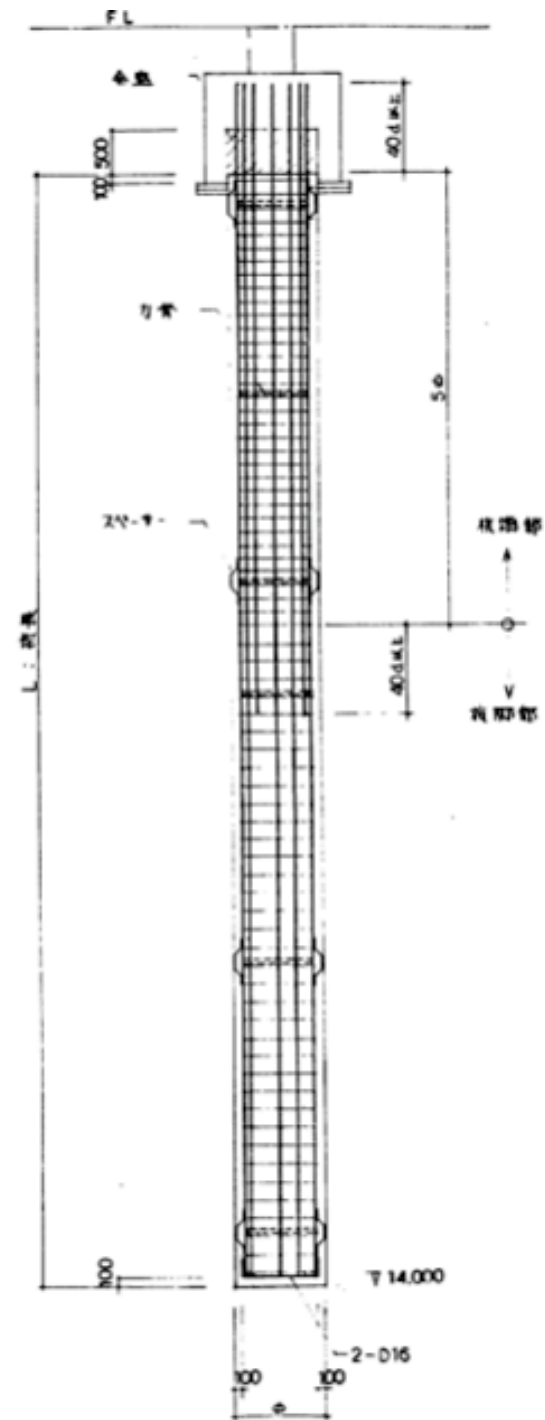

Floor structure for ATF2 beam line

Refurbishment from Jun to Sep 2007

Structure is same as that of DR.

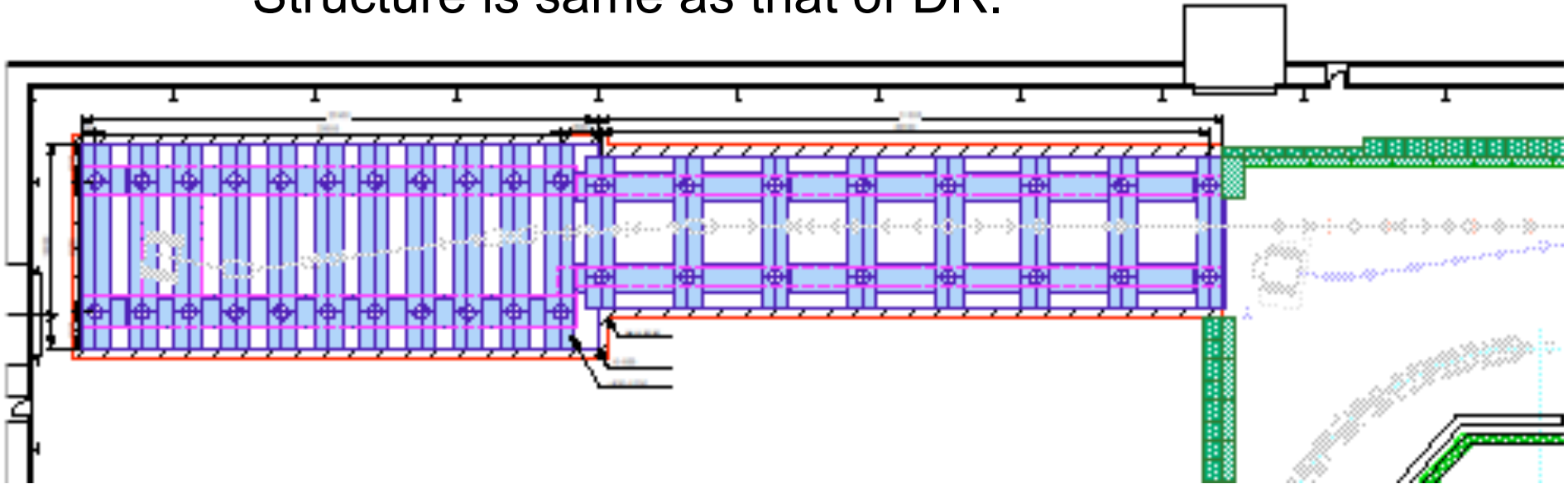

Radiation shields

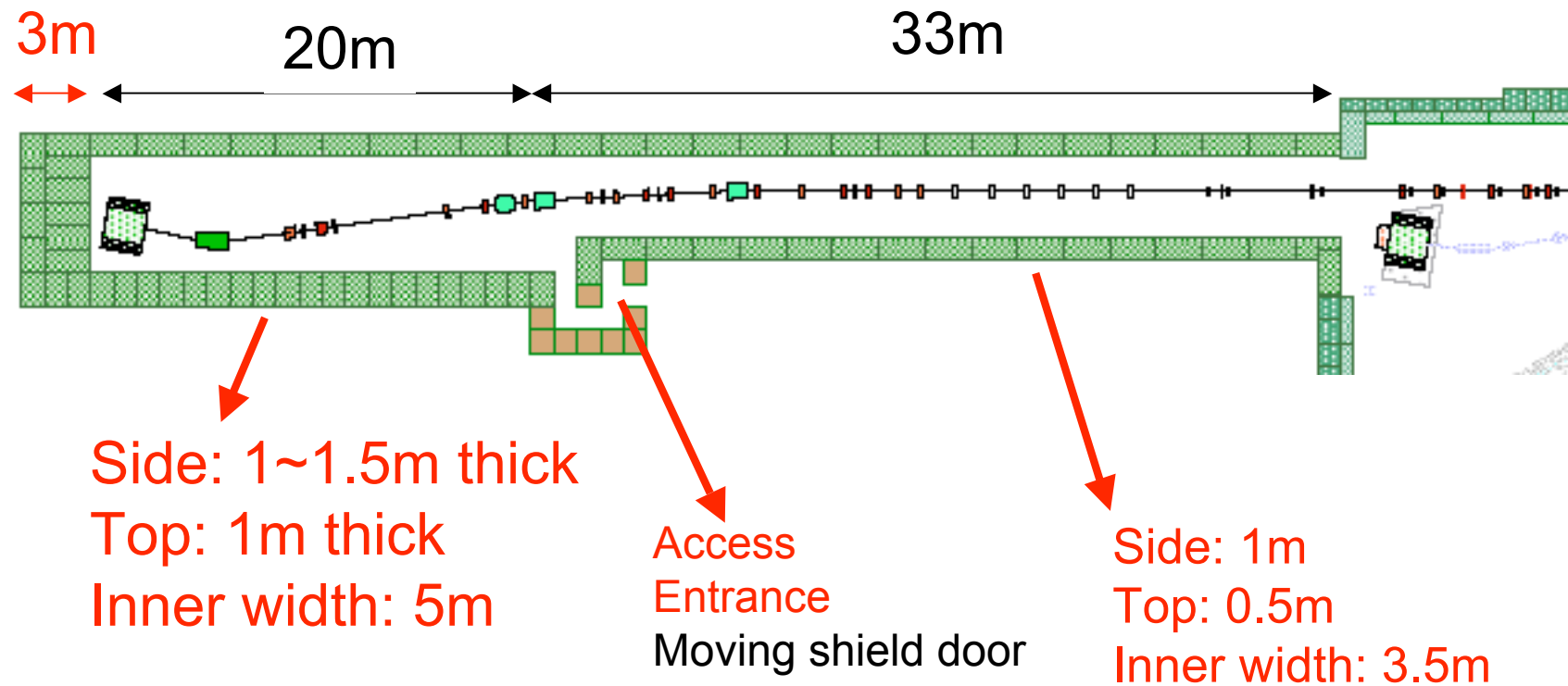

Modify the radiation shield of the ATF2 joint section

Full extension of ATF2 shields will be started after October 2007.

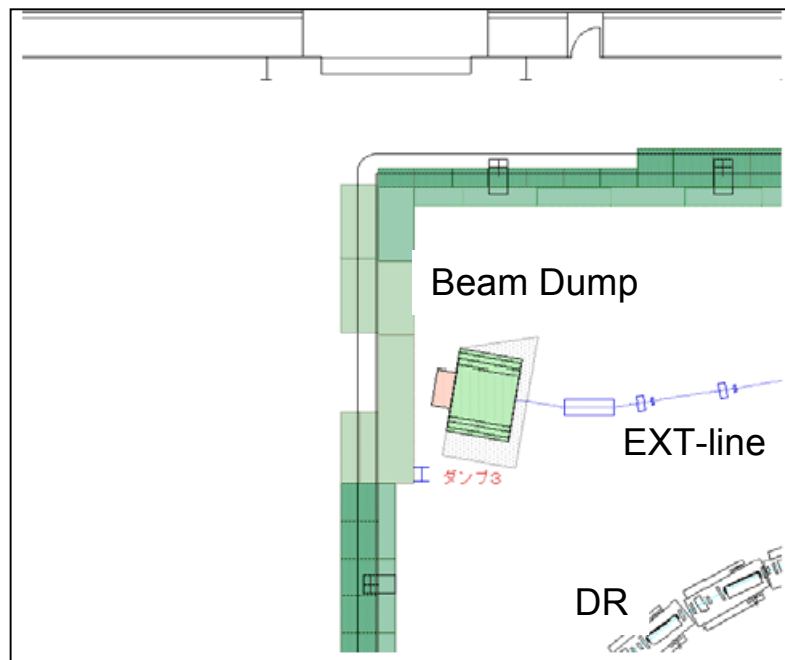

May 2007

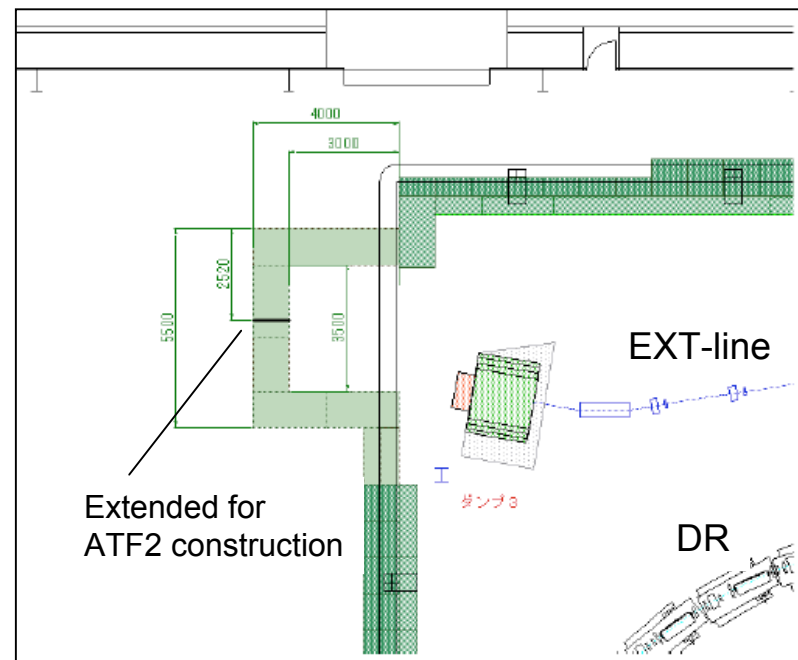

October 2007

Final layout of ATF radiation shields 2008 ~

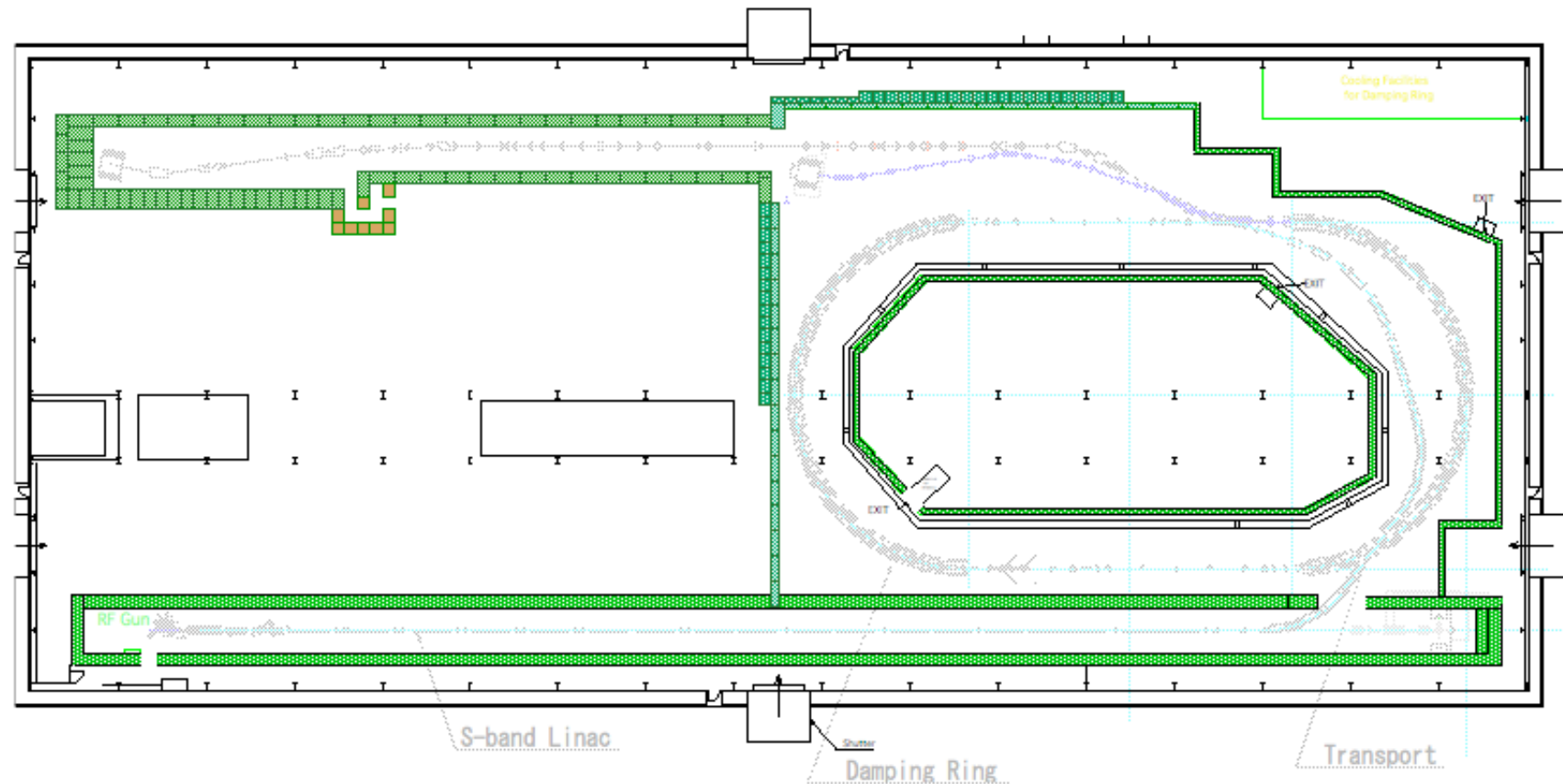

2007/Mar/02 N.Terunuma, KEK